

QUANTITY REQUIRED _____

Door Handing is as viewed from the hinged side as the leaf opens towards you

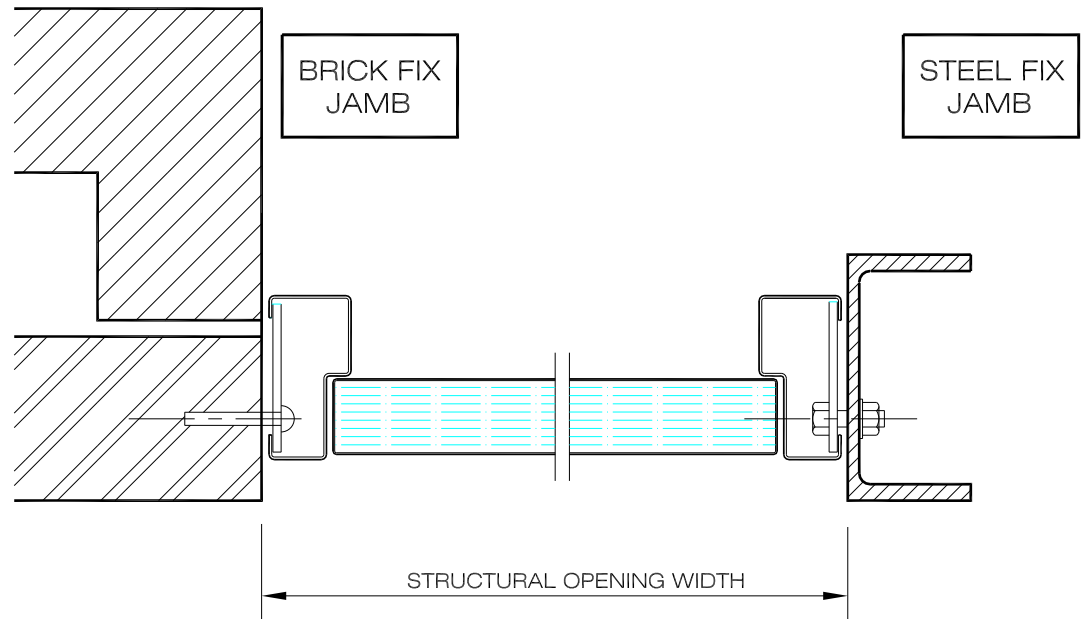
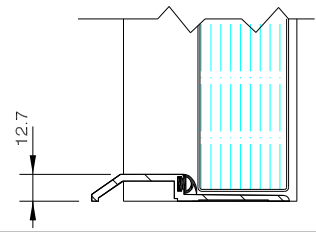

STANDARD DOOR SIZES
 To suit structural opening:-
 900 wide x 2100 high
 1000 wide x 2100 high

SPECIFICATION	
HARDWARE OPTIONS Latch & Pair of Levers <input type="checkbox"/> Sashlock, Cyl & Turn, Pair of Levers <input type="checkbox"/> Deadlock, Cyl & Turn, Pull Handles <input type="checkbox"/> IDC 767 Rim Panic Pad <input type="checkbox"/> IDC 757 Rim Panic Latch <input type="checkbox"/> IDC 737 2 point Panic Bolt <input type="checkbox"/> IDC 777 External override with Euro cylinder <input type="checkbox"/> Ryobi Door Closer <input type="checkbox"/> Friction Stay <input type="checkbox"/> St. Steel Kick Plates: Qty _____ <input type="checkbox"/> Sweep (Wheel chair Threshold) <input type="checkbox"/>	THRESHOLD DETAILS 
FINISH Leaf: Primed <input type="checkbox"/> BS / RAL <input type="checkbox"/> Frame: Primed <input type="checkbox"/> BS / RAL <input type="checkbox"/> FIRE RATING: N/A <input type="checkbox"/> 60 min <input type="checkbox"/> 120 min <input type="checkbox"/> INFILL: Honeycomb <input type="checkbox"/> Mineral wool <input type="checkbox"/>	FRAME DETAILS 